

PN - 99-EK-A16866

***Harrop TVS2650 MK2 LS1 Port
Supercharger kit – MAX EFFORT***



ENGINEERING PERFORMANCE SINCE 1955

PN - 99-EK-A16865

**Harrop TVS2650 MK2 LS1 Port
Supercharger kit – MAX EFFORT**

ITEM		DESCRIPTION	QTY
1	PART	MANIFOLD, SUPERCHARGER, HTV2300, LS1-2	1
2	ASSEMBLY	CORE, INTERCOOLER (6MM FIN, 2MM TUBE), LH, FDFI, L76	1
3	ASSEMBLY	CORE, INTERCOOLER (6MM FIN, 2MM TUBE), RH, FDFI, L76	1
4	PART	RETAINER, INTERCOOLER, FDFI, L76	2
5	PART	SCREW, CAP, BUTTON HEAD, M6 x 10, GEOMET500A	2
6	PART	RETAINER, MAP-SENSOR, 16212460, LS112	1
7	PART	SENSOR, MAP, 2.7-BAR, GM 12592525	1
8	PART	HOSE, INTERCOOLER, 5/8", 650 LONG	1
9	PART	HOSE, INTERCOOLER, 5/8", 430 LONG	1
10	PART	HOSE, INTERCOOLER, 5/8", 540 LONG	1
11	PART	HOSE, INTERCOOLER, 5/8", 300 LONG	1
12	ASSEMBLY	FITTING, Y, 16, TO, 19	1
13	PART	CLAMP, COBRA, FUEL INJECTION, 22mm, NORMA, 65-COBRA-22/8-W4	6
14	PART	PLUG, PRESSURE, 1/8 BSPT, ZINC PLATED	2
15	PART	DOWEL, PIN, Ø5.0 x 16 LONG	2
16	PART	MOUNT, RAIL, FUEL, FRONT, LHS, LS112	1
17	PART	MOUNT, RAIL, FUEL, FRONT, RHS, LS112	3
18	PART	SENSOR, TEMPERATURE, 25037388, GM	1
19	PART	RAIL, FUEL, LS112	2
20	PART	SCREW, CAP, SOCKET HEAD, M5 x 12, ZINC PLATED	8
21	PART	PLUG, 3/4 16, SPEEDFLOW, 814-8	1
22	PART	SCREW, SOCKET HEAD CAP, M6 x 80, ZINC PLATED	5
23	ASSEMBLY	HOSE, FUEL, GM	1
24	ASSEMBLY	HOSE, CROSSOVER, PL-HRP98-1	1
25	ASSEMBLY	SUPERCHARGER, HTV2650, FDFI, LUG-MNT, VERTICAL ACT CW, NO INLET	1
26	PART	BOLT, FLANGED HEAD, M6 x 25, GEOMET500A	5
27	PART	SCREW, SOCKET HEAD CAP, M6 x 100, GEOMET500A	5

KIT ALSO INCLUDES:

RIVOT BLINE ASP-5-4, x 8

LOCTITE 518 6ML

SUPERCHARGER PINNING KIT, x 1

HARROP ENHANCED BADGE, x 1

M8 x 25 BUTTON HEAD CAP SCREWS, ZINC, x 11

INSTALL WARRANTY GUIDE (BUSINESS CARD), x 1

#10124 LOOM PATCH MAF & REMOTE TEMP SENSOR VE, x 1

#16858 MANIFOLD I/C S/C HTV360Mk2 LS3 UNIVERSAL EXCLUDING COVER

#10922 MOUNT ASSEMBLY IDLER 10PK FDFI

#14751 GASKET INSULATOR MANIFOLD LS1 FDF1 S/CHARGER

#15547 10PK TENSIONER PULLEY, X 1

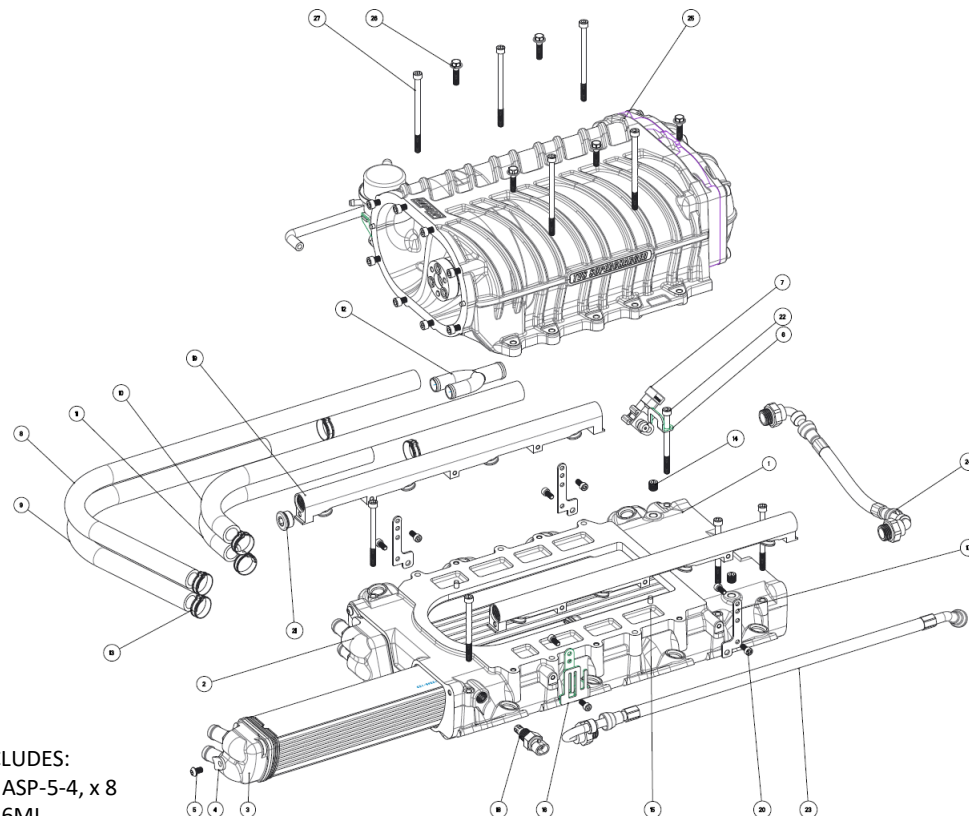

ENGINEERING PERFORMANCE SINCE 1955



PN - 99-EK-A16866

Harrop TVS2650 MK2 LS1 Port

Supercharger kit – MAX EFFORT

Ø110mm ETC front cover

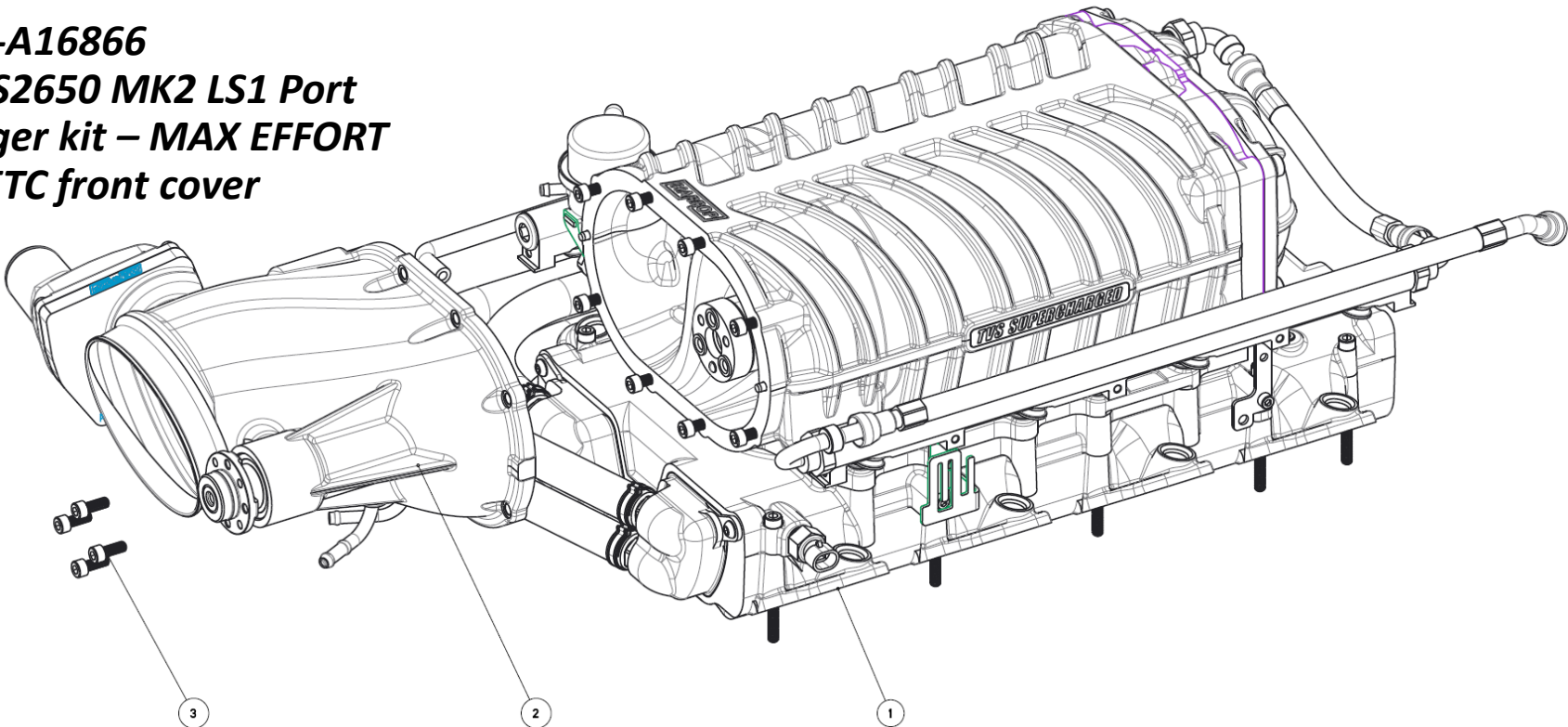

ITEM		DESCRIPTION	QTY
1	ASSEMBLY	MANIFOLD, S/CHARGER ASSY, TVS2650-Mk2, LS1/2-MAX ENG KIT EXCL CVR	1
2	ASSEMBLY	COVER, INLET, FDFI2650, Ø110, LS3	1
3	PART	SCREW, SOCKET HEAD CAP, M6 x 16, TUFLOC 360, GEOMET500A	4

KIT ALSO INCLUDES:

#15094-GT PULLEY

#12953 UNIVERSAL INTERCOOLER KIT

#15296 PULLEY CRANK ø245mm / 23% OD 10PK SUIT ATI

PN - 99-EK-A16864

***Harrop TVS2650 MK2 LS3 Port
Supercharger kit – MAX EFFORT***



ENGINEERING PERFORMANCE SINCE 1955

Tech Guide

FDFI TVS2650 MK2 MAX Supercharger kit



PN - 99-EK-A16863

Harrop TVS2650 MK2 LS3 Port Supercharger kit – MAX EFFORT

ITEM	DESCRIPTION	QTY
1	BOLT, FLANGED HEAD, M6 x 25, GEOMET500A	5
2	CLAMP, COBRA, FUEL INJECTION, 22mm, NORMA, 65-COBRA-22/8-W4	6
3	CORE, INTERCOOLER (6MM FIN, 2MM TUBE), LH, FDFI, L76	1
4	CORE, INTERCOOLER (6MM FIN, 2MM TUBE), RH, FDFI, L76	1
5	DOWEL, PIN, Ø5.0 x 16 LONG	2
6	FITTING, Y, 16, TO, 19	1
7	HOSE, CROSSOVER, PL-HRP98-1	1
8	HOSE, FUEL, GM	1
9	HOSE, INTERCOOLER, 5/8", 300 LONG	1
10	HOSE, INTERCOOLER, 5/8", 430 LONG	1
11	HOSE, INTERCOOLER, 5/8", 540 LONG	1
12	HOSE, INTERCOOLER, 5/8", 650 LONG	1
13	MANIFOLD, S/CHARGER ASSY, TVS2650-Mk2, LS3-MAX ENG KIT EXCL CVR	1
14	MANIFOLD, SUPERCHARGER, HTV2300, FDFI, L-76	1
15	MOUNT, RAIL, FUEL, SUPERCHARGER, FDFI, L76	4
16	PLUG, 3/4 16, SPEEDFLOW, 814-8	1
17	PLUG, PRESSURE, 1/8 BSPT, ZINC PLATED	1
18	RAIL, FUEL, SUPERCHARGER, FDFI, L76	2
19	RETAINER, INTERCOOLER, FDFI, L76	2
20	RETAINER, MAP, FDFI, 2-7 BAR, FRONT MOUNT	1
21	SCREW, BUTTON HEAD CAP, M6x12, GEOMET500A	1
22	SCREW, CAP, BUTTON HEAD, M6 x 10, ZINC PLATED	1
23	SCREW, SOCKET HEAD CAP, M6 x 100, GEOMET500A	5
24	SCREW, SOCKET HEAD CAP, M6 x 12, ZINC PLATED	8
25	SCREW, SOCKET HEAD CAP, M6 x 80, ZINC PLATED	5
26	SENSOR, MAP, 2.7-BAR, GM 12592525	1
27	SENSOR, TEMPERATURE, 25037388, GM	1
28	SUPERCHARGER, HTV2650, FDFI, LUG-MNT, VERTICAL ACT CW, NO INLET	1

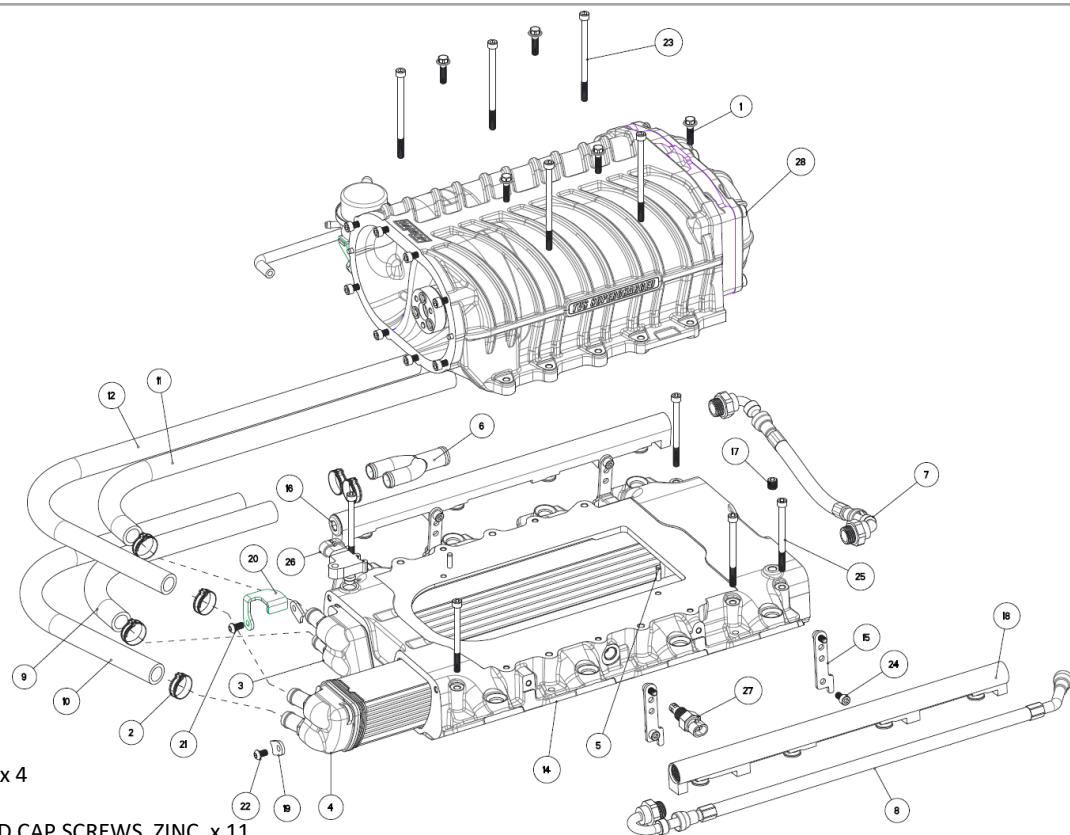

KIT ALSO INCLUDES:

RIVOT BLINE ASP-5-4, x 4
LOCTITE 518 6ML
M8 x 25 BUTTON HEAD CAP SCREWS, ZINC, x 11
48-FLN-M6 FLANGED NUT PLATED - M6 - ZINC BLUE, x 4
SUPERCHARGER PINNING KIT, x 1
HARROP ENHANCED BADGE 30 x 80, x 1
INSTALL WARRANTY GUIDE (BUSINESS CARD), x 1
#10124 LOOM PATCH MAF & REMOTE TEMP SENSOR VE, x 1
#15039 MOUNT ASSEMBLY IDLER LSA 10PK FDFI
#11510 COVER VALLEY LS3 FDFI
#12526 GASKET INSULATOR MANIFOLD S/CHARGER
#15547 10PK TENSIONER PULLEY, X 1

ENGINEERING PERFORMANCE SINCE 1955

5

04/04/2024



PN - 99-EK-A16864
Harrop TVS2650 MK2 LS3 Port
Supercharger kit – MAX EFFORT
Ø110mm ETC front cover

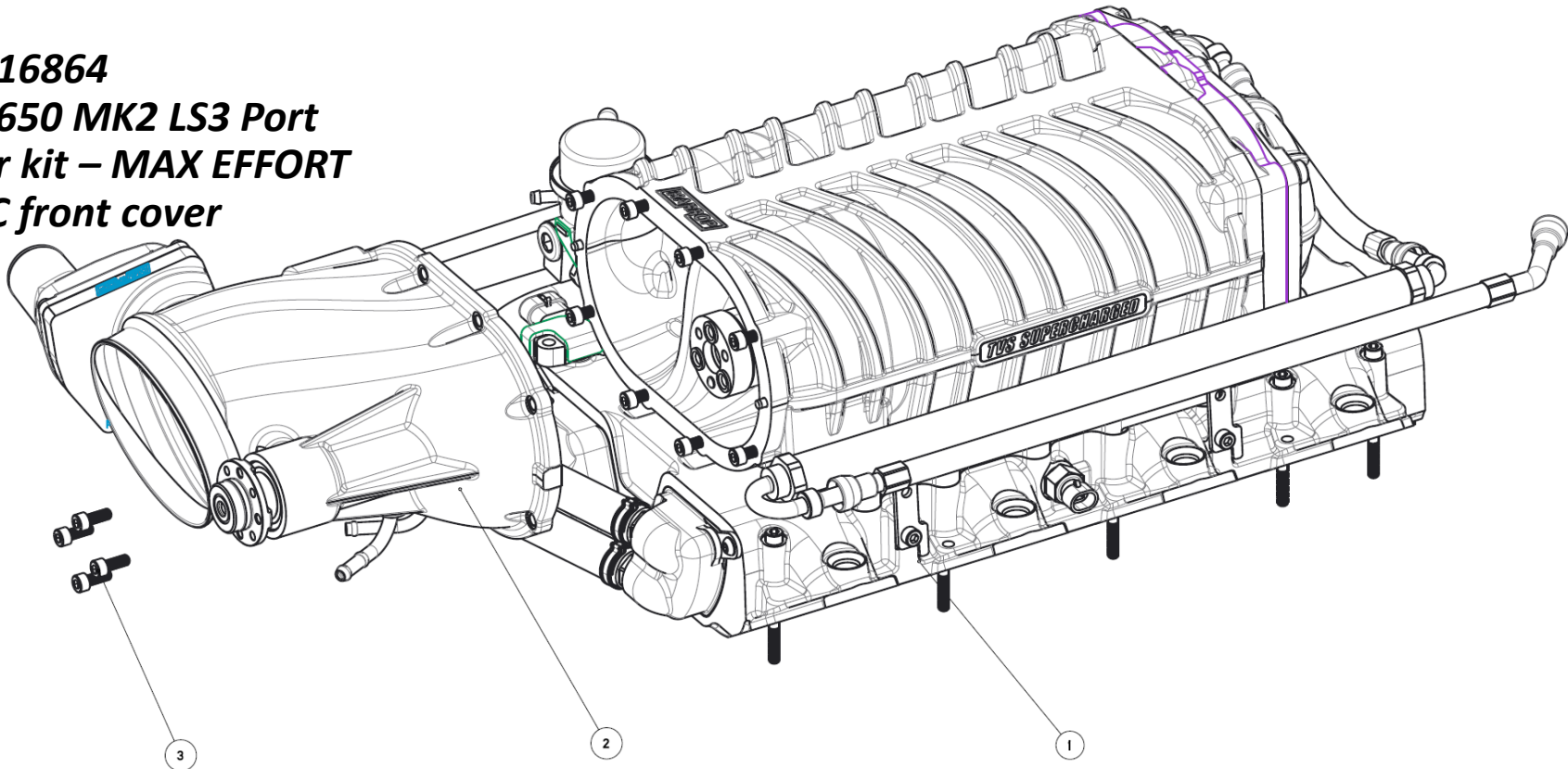

ITEM		DESCRIPTION	QTY
1	ASSEMBLY	MANIFOLD, S/CHARGER ASSY, TVS2650-Mk2, LS3-MAX ENG KIT EXCL CVR	1
2	ASSEMBLY	COVER, INLET, FDFI2650, Ø110, LS3	1
3	PART	SCREW, SOCKET HEAD CAP, M6 x 16, TUFLOC 360, GEOMET500A	4

KIT ALSO INCLUDES:
#15094-GT PULLEY
#12953 UNIVERSAL INTERCOOLER KIT
#15296 PULLEY CRANK ø245mm / 23% OD 10PK SUIT ATI

Fuel System

- Manifold assembly will accept EV14 Long body injectors with 14.6mm o-ring's both ends such as DeatschWerks 18U-00-0088-8.
- Fuel hoses included to connect to GM quick connect. Rail fitting size is -8 ORB both ends.

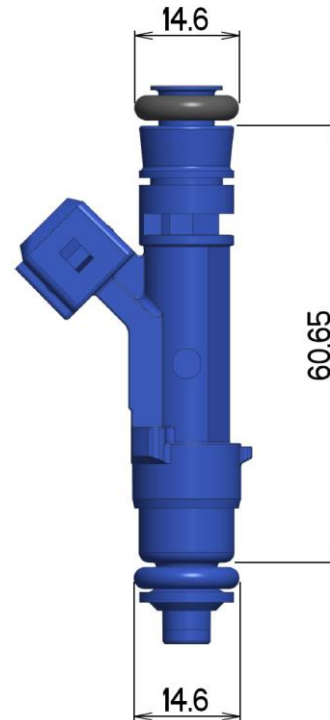

Harrop Universal Intercooler Kit

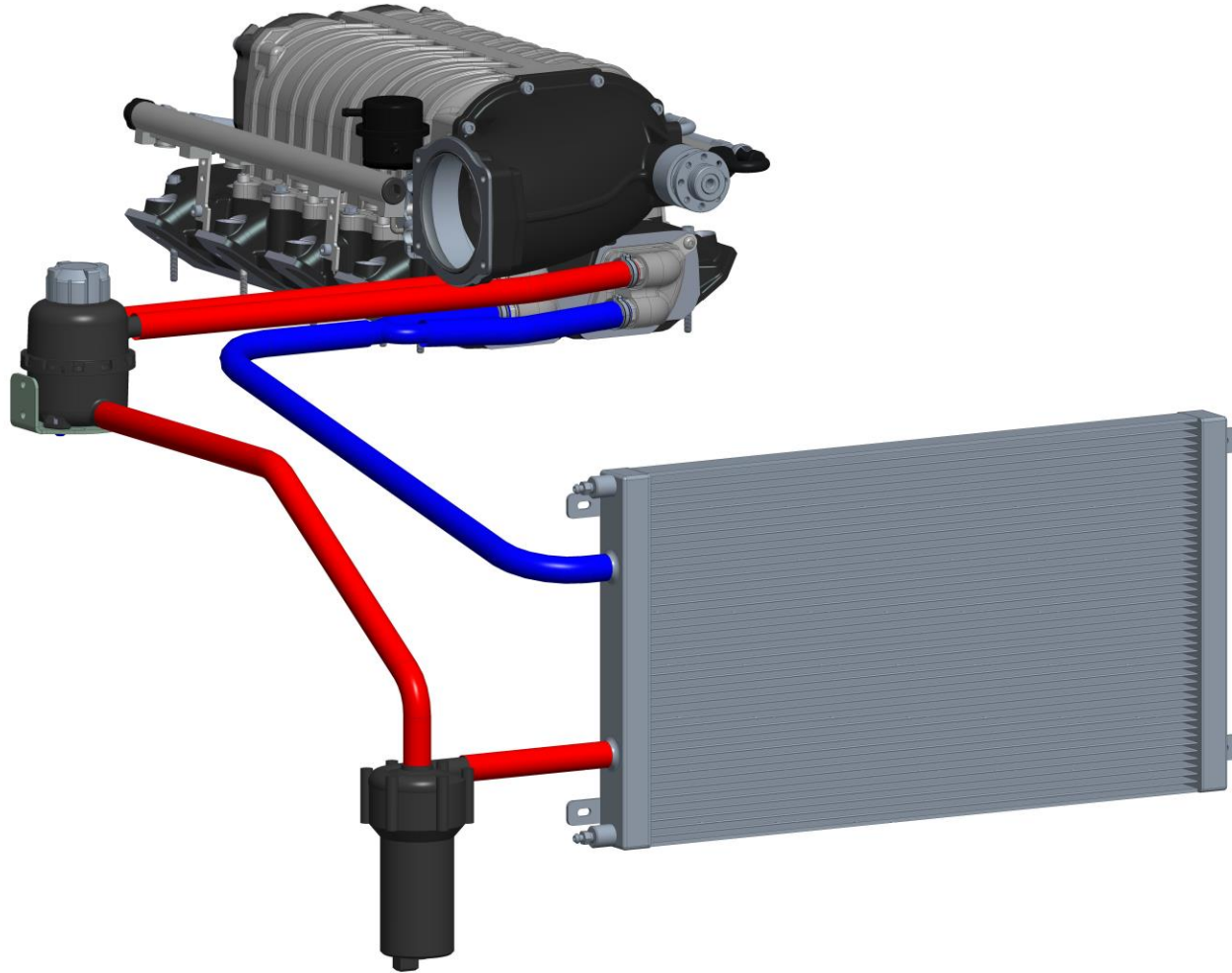

ENGINEERING PERFORMANCE SINCE 1955

Accessory Drive

Supercharger Pulley

MAX LS 10PK	Diameter	Minus 20.3 offset	Belt
	85mm	99-PLY15095-GT	10PK1980
	80mm	99-PLY15094-GT	10PK1980
	75mm	99-PLY15093-GT	10PK1962
	70mm	99-PLY15092-GT	10PK1962
	65mm	99-PLY15091-GT	10PK1943

Required parts not included in kit

OEM LSA supercharger belt tensioner
OEM LSA supercharger belt tensioner bracket
OEM LSA water pump
ATI 918854 balancer
Supercharger belt

Belt Routing

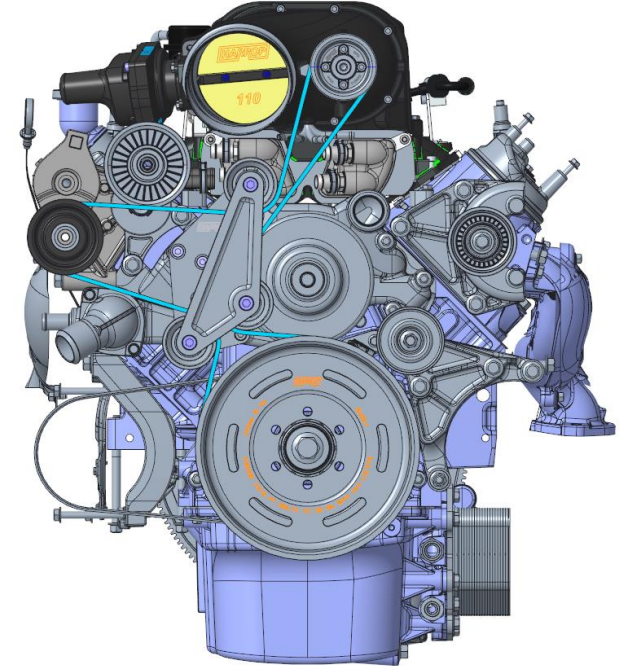

- The Eaton TVS2650 rotating group is validated up to 18,000 supercharger RPM. Exceeding this supercharger speed will void the supercharger product warranty.



Integrated Ø110mm ETC inlet piping

- The OD of the integrated throttle body is Ø118mm.
- Ensure that when designing the inlet piping into the throttle, there is adequate room between the inlet piping and the supercharger belt, especially for the larger supercharger pulley sizes.