

# Tech Guide

## H2650i LSA Engine kit

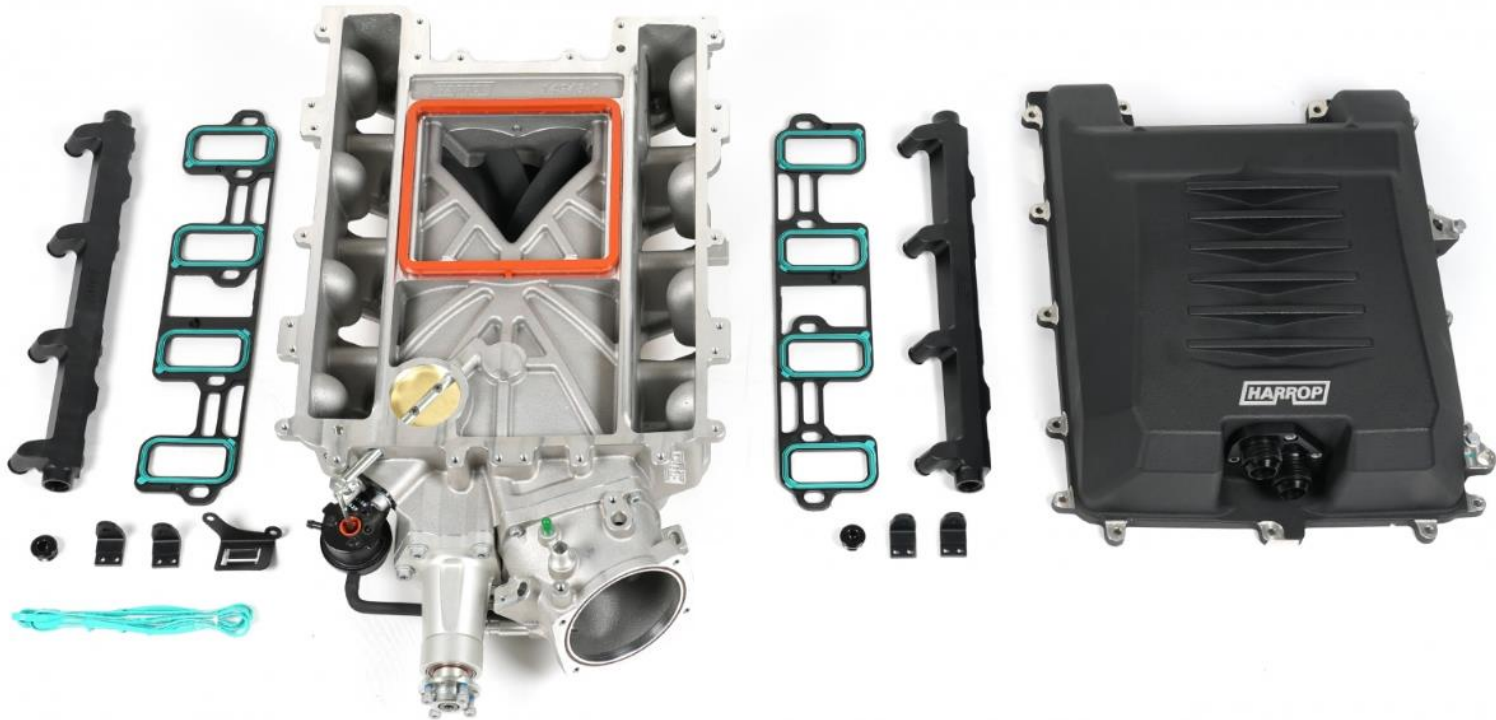

**PN - 99-EK-A16868**  
**Harrop TVS2650 H2650i LSA**  
**Supercharger kit**



ENGINEERING PERFORMANCE SINCE 1955

1  
04/04/2024

# Tech Guide

## H2650i LSA Engine kit



### PN - 99-EK-A16868

### Harrop TVS2650 H2650i LSA

### Supercharger kit

ITEM	DESCRIPTION	QTY	DRAWING
1	FITTING, 2 x DASH 16, INTERCOOLER, LSA	1	15112-1
2	GASKET, INSULATOR, MANIFOLD, SUPERCHARGER, HARROP	2	12526-0
3	GASKET, LSA LID, 12613457	1	-
4	KIT, FUEL RAIL LSA H2650i	1	A15743-1
5	MANIFOLD, SUPERCHARGER, ASSEMBLY, LSA2650	1	A14942-2
6	MANIFOLD, UPPER, LSA	1	A15045-3
7	RIVET, BLIND, ASP-5-4	4	-
8	SEAL, LSA INTERCOOLER PLENUM	1	16680-0

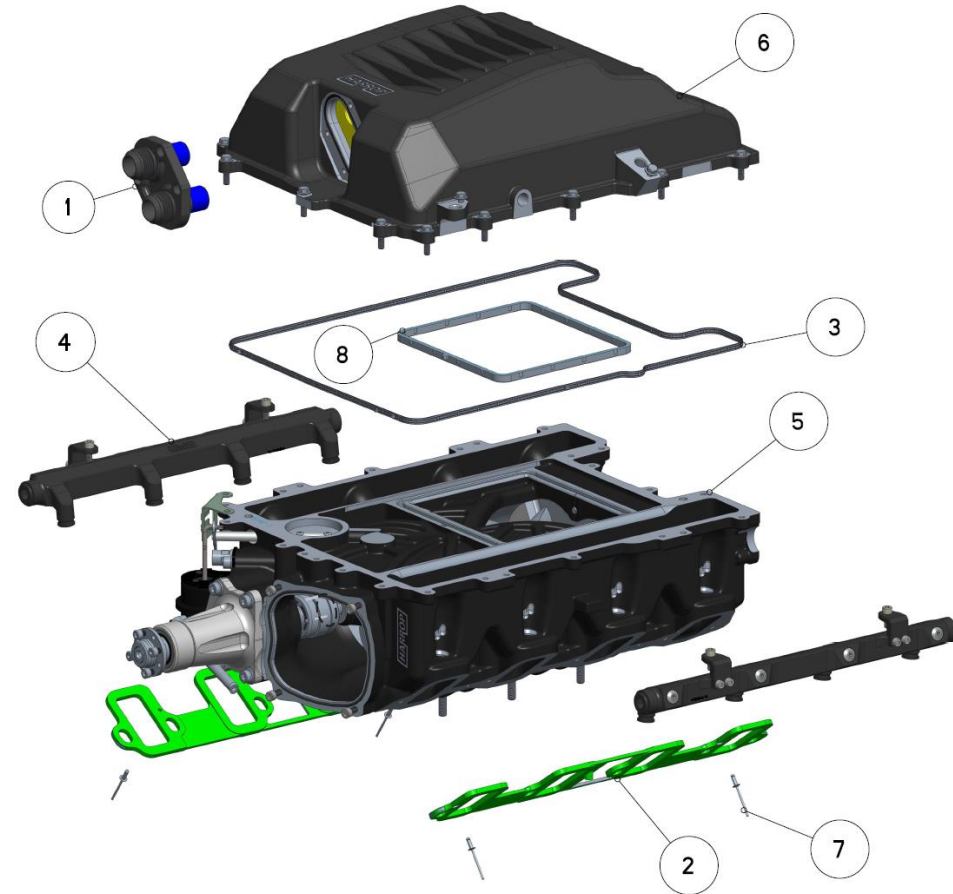

ENGINEERING PERFORMANCE SINCE 1955

2

04/04/2024

### *Fuel System*

- Manifold assembly will accept EV14 compact injectors with a 14.6mm top O-ring and 15.5mm bottom O-ring such as DeatschWerks 16U-00-0065-8.
- Rail fitting size is -8 ORB both ends.
- Fuel rails also have side plugs opposite each injector with an M10x1.0 ORB port.

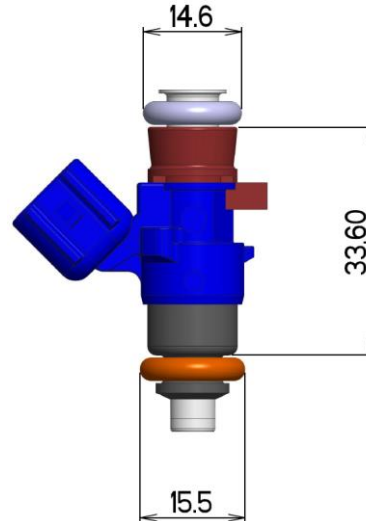

### Accessory Drive

#### Supercharger Pulley

H2650i LSA 8PK	Diameter	Supercharger Pulley	Belt
	90mm	99-PLY15009-GT	8PK1680
	85mm	99-PLY15008-GT	8PK1680
	80mm	99-PLY15007-GT	8PK1660
	75mm	99-PLY15006-GT	8PK1660
	70mm	99-PLY15005-GT	8PK1650
	65mm	99-PLY15004-GT	8PK1650

#### Belt Routing

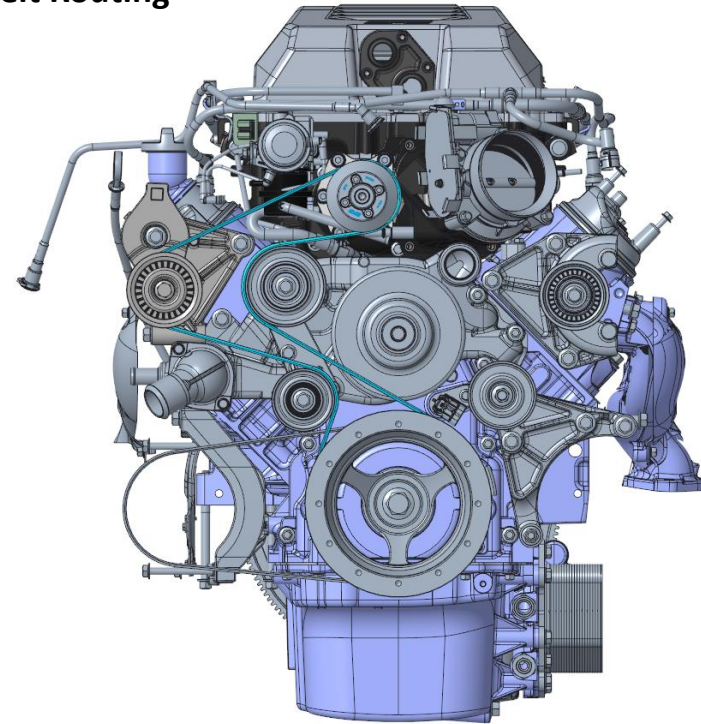

- The Eaton TVS2650 rotating group is validated up to 18,000 supercharger RPM. Exceeding this supercharger speed will void the supercharger product warranty.